

# DE396 ANGLED SEPARATOR DUNNAGE

## 1.63" INDEX

## 10 DEG ANGLE

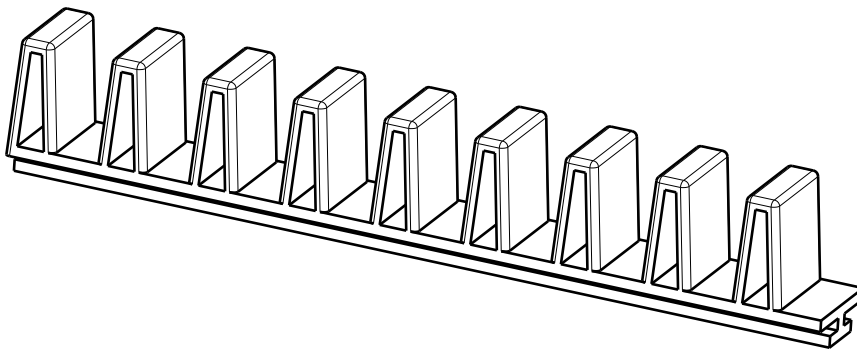
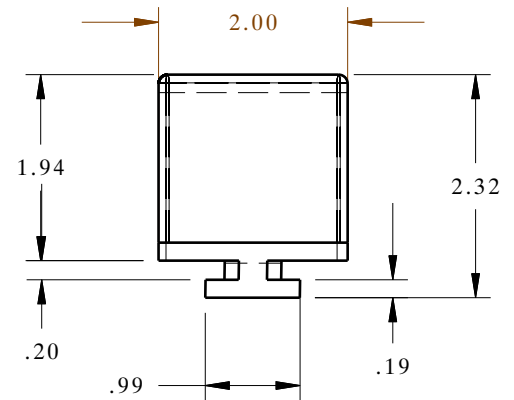
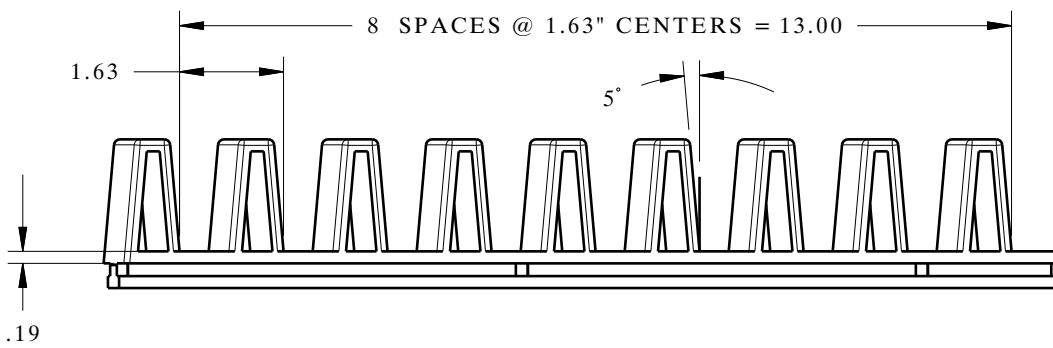
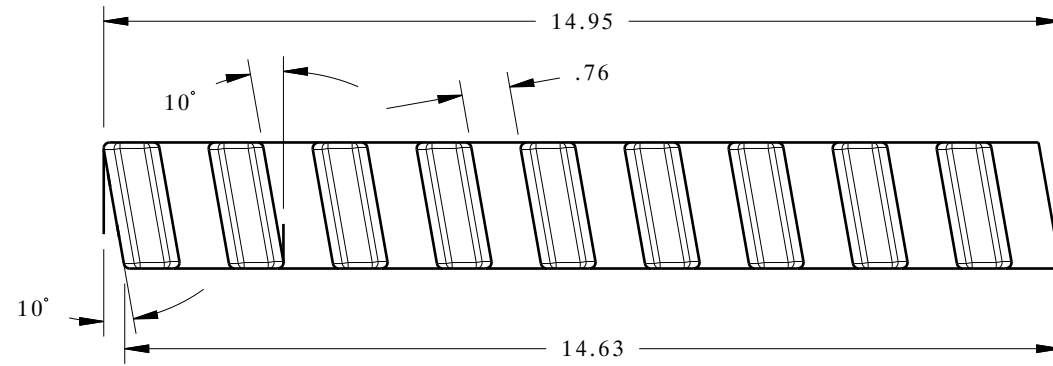

<b>DE396-R</b>	<b>SHOWN</b>
<b>DE396-L</b>	<b>OPPOSITE</b>

<b>MATERIAL TYPE</b>	<b>Thermoplastic Elastomer (TPE)</b>
<b>HARDNESS (SHORE A)</b>	<b>90 (Stock), Call</b>
<b>COLOR</b>	<b>Gray (Stock)</b>

**1.63" INDEX, .76" POCKET**

**Applications:**

- Base Dunnage - Curved Panel
- Side Dunnage - panel with 10' Lean



**800-443-5553**      [www.dunnage-eng.com](http://www.dunnage-eng.com)