

DE1132 C-CHANNEL END CAP (CMHE4618)

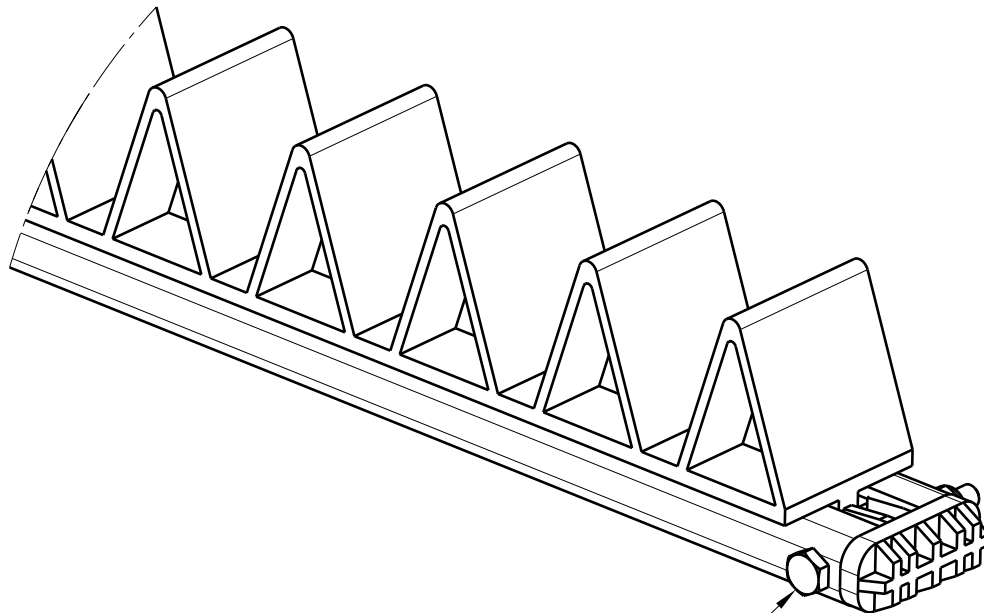
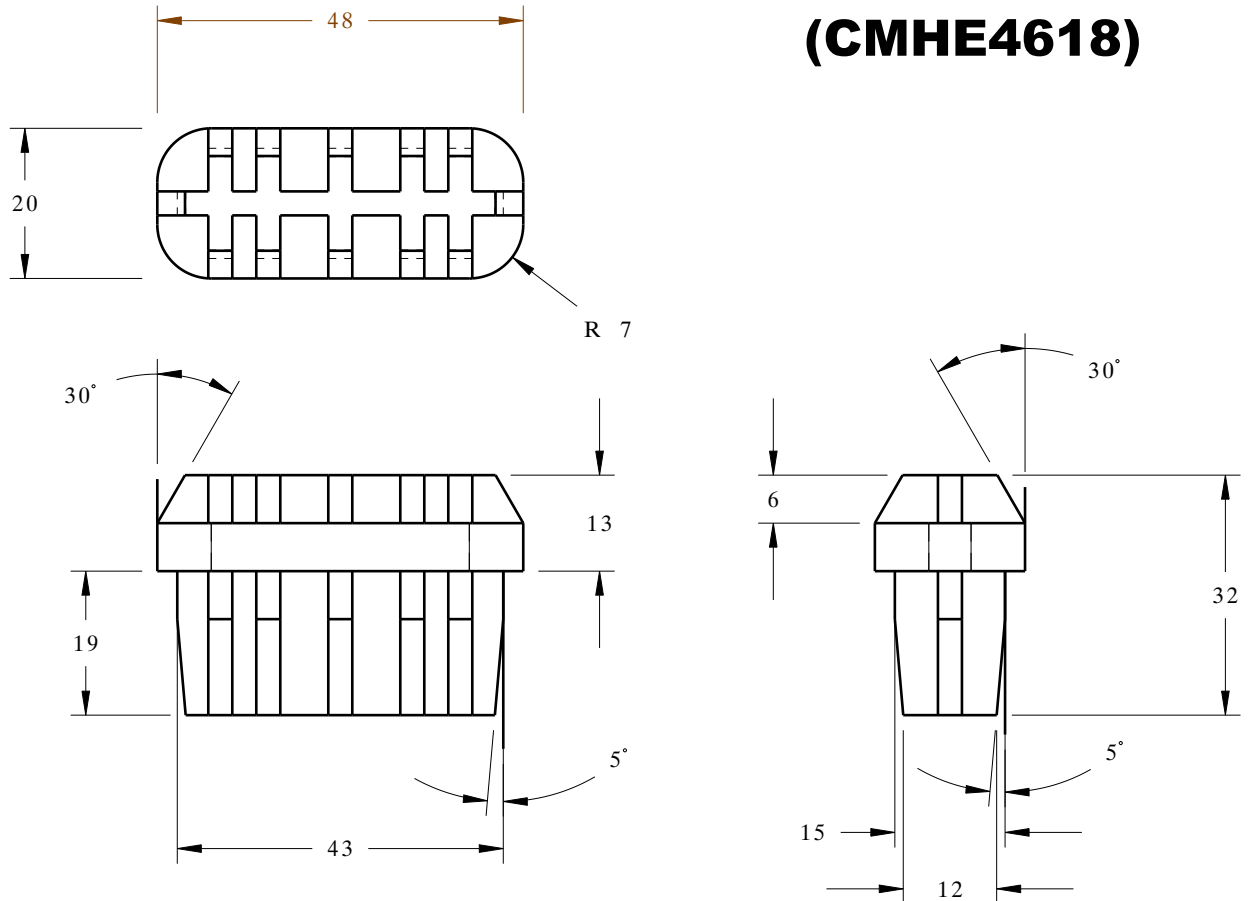

(SHOWN FOR REF.)
PROVIDE HOLES FOR
6mm BOLT ASSEMBLY
TO SECURE END CAP

Note: All Dimensions are in Millimeters

MATERIAL TYPE	Thermoplastic Elastomer (TPE)
HARDNESS	90A
COLOR	Black

C-CHANNEL END CAP

Applications: Secure T-track
Dunnage at end of
C-Channel



800-443-5553

www.dunnage-eng.com