

Comb Dunnage

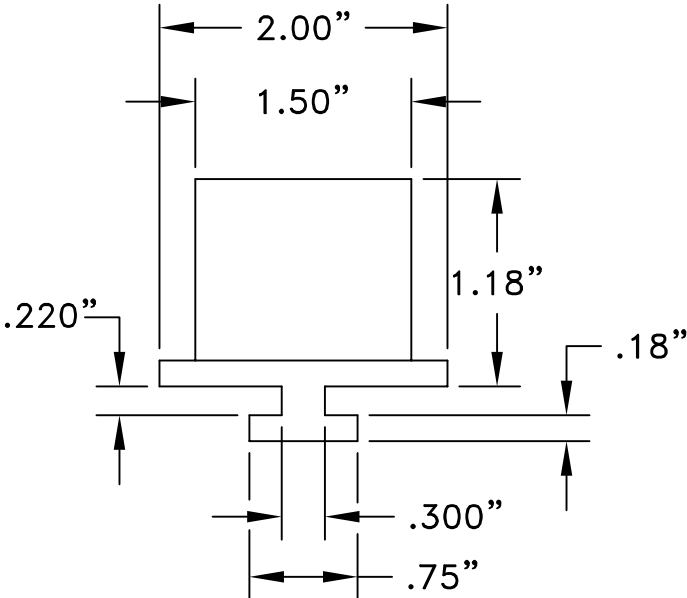

DE-003A

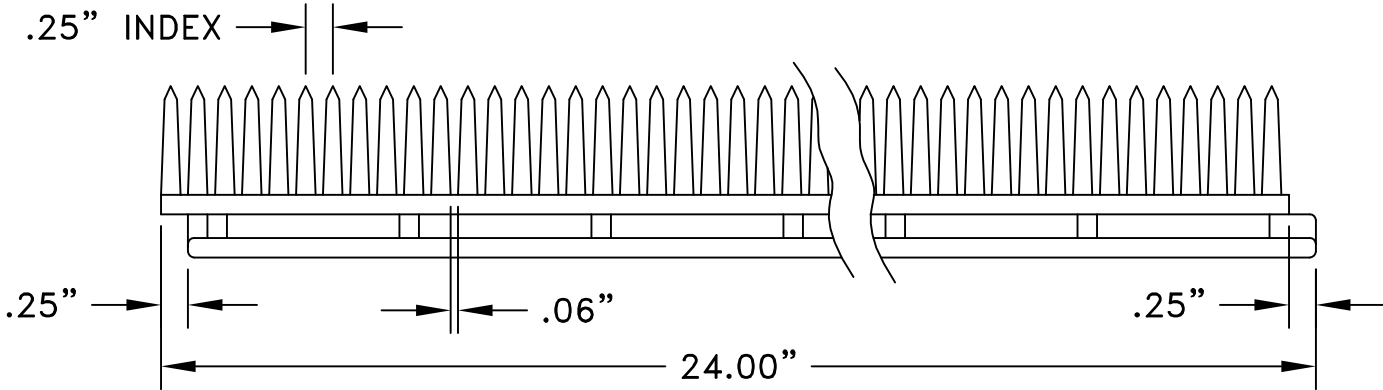
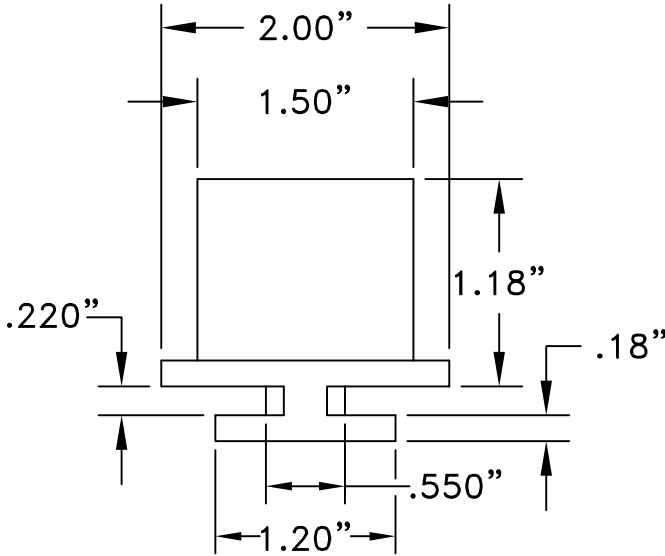

DE-003E

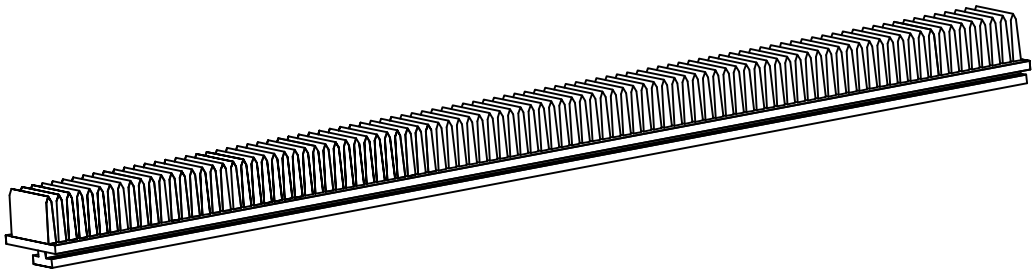

Tooling Property Of:



Typical uses:

1. Swing arm (close-off) dunnage
2. Cantilever arm dunnage
3. Sheet metal panel dunnage
4. Glass panel dunnage

Standards:

- F.M.C. (48ZF-4235)
GM
CHRYSLER

MATERIAL TYPE Thermoplastic Elastomer (TPE)
HARDNESS (SHORE A) 70, 80, 90, Call
COLOR Grey, Black, Call

Comb Dunnage

Applications:
-Generic close-off
-Captures part flange

Dunnage Engineering
Brighton, Michigan

800-443-5553 www.dunnage-eng.com