

XL BRUSH DUNNAGE

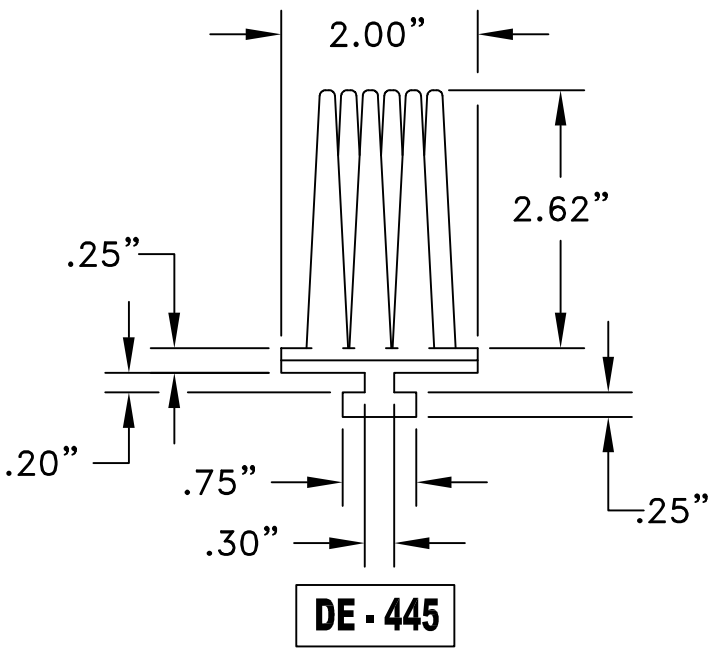

DE - 445

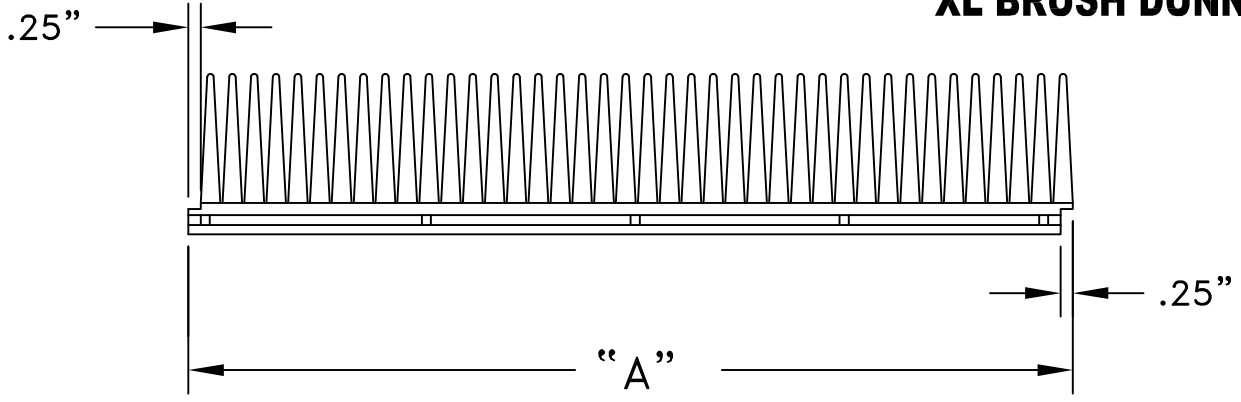
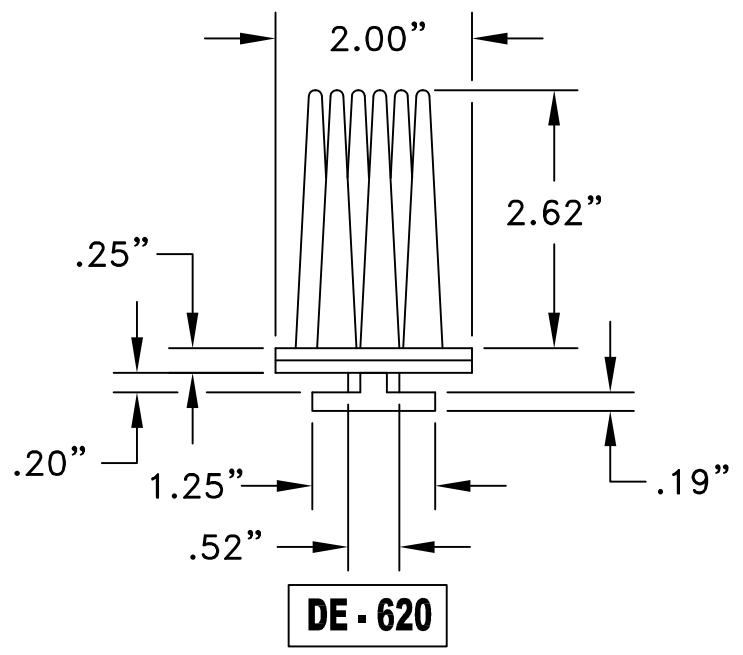

DE - 620

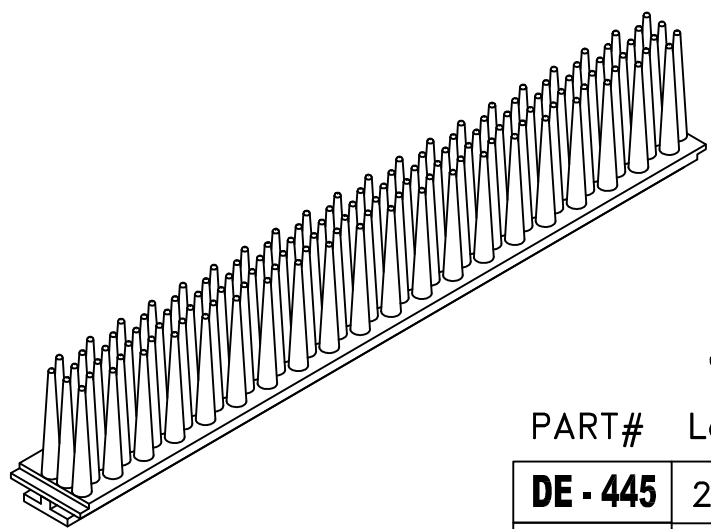

PART#	"A" Length	Fits Slot Size
DE - 445	26.00"	.313"
DE - 620	18.00"	.625"

MATERIAL TYPE Thermoplastic Elastomer (T.P.E.)
HARDNESS (SHORE A) 70 (Soft), 80, 90
COLOR Grey, Black, Call

XL BRUSH DUNNAGE (2.625")

Applications:
 -Generic part spacing
 -Captures part flanges

Dunnage Engineering
 Brighton, Michigan
 800-443-5553 www.dunnage-eng.com