

# COMB DUNNAGE

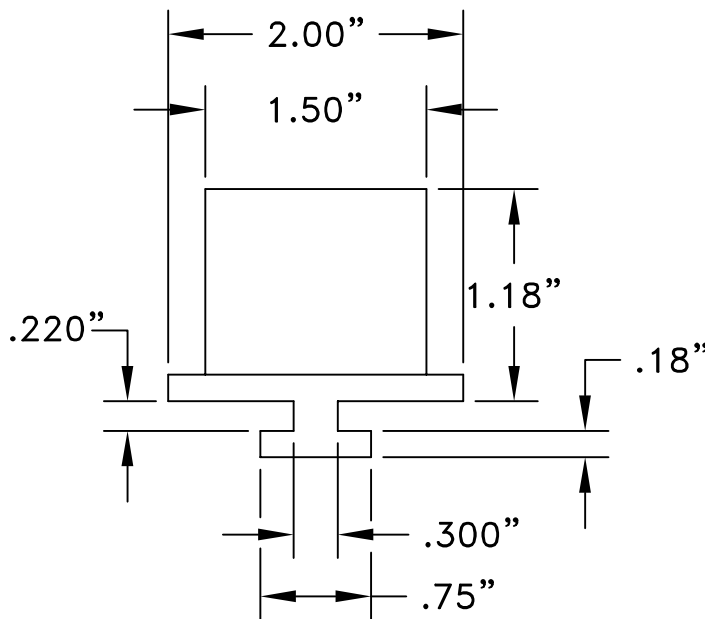

**DE-003A**

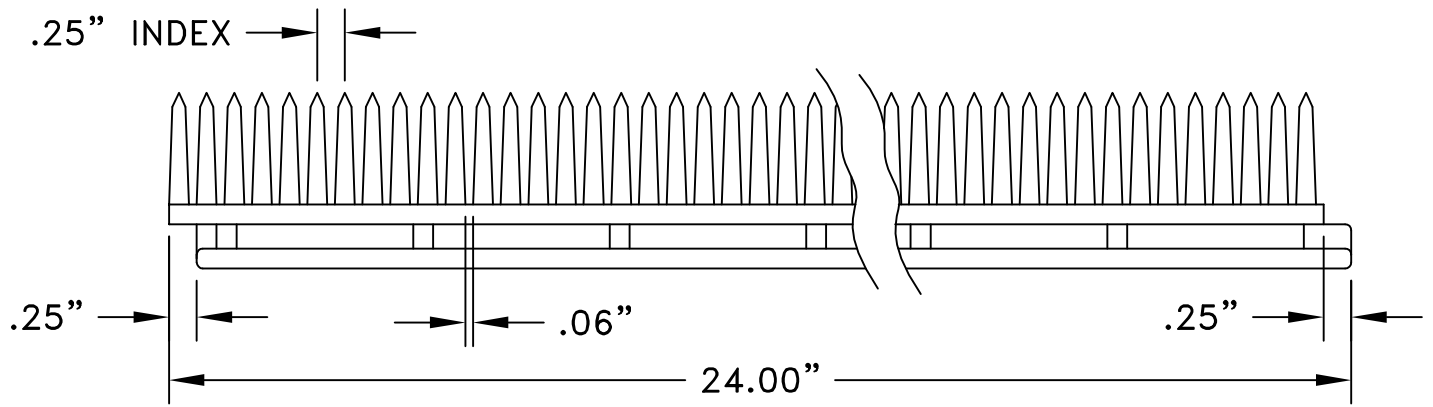
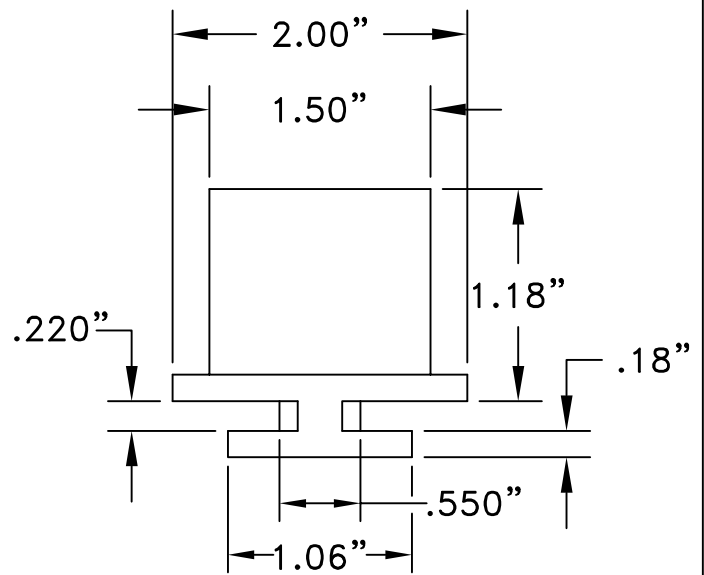

**DE-003E**

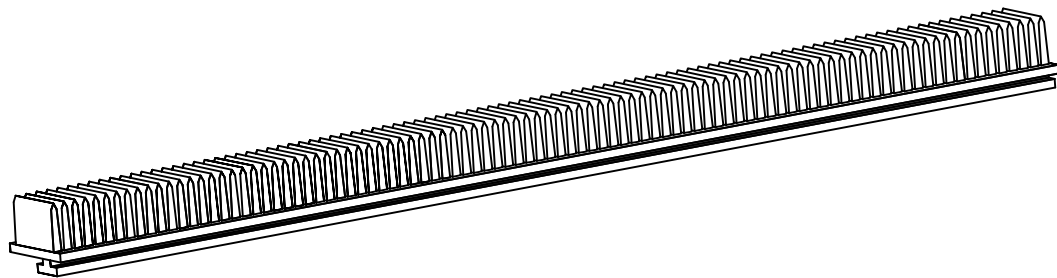

Typical uses:

1. Swing arm (close-off) dunnage
2. Cantilever arm dunnage
3. Sheet metal panel dunnage
4. Glass panel dunnage

<b>MATERIAL TYPE</b> Thermoplastic Elastomer (TPE)
<b>HARDNESS (SHORE A)</b> 70, 80, 90, Call
<b>COLOR</b> Grey, Black, Call

## COMB DUNNAGE

Applications:  
 -Generic close-off  
 -Captures part flange



800-443-5553

www.dunnage-eng.com